



Experience Smart Factory Solutions Lunch & Learn

June 10, 2019 | 11:30 am – 1:30 pm

Location

Manufacturers Resource Center | Hanover Office Plaza
961 Marcon Boulevard, Suite 200 | Allentown, PA 18109

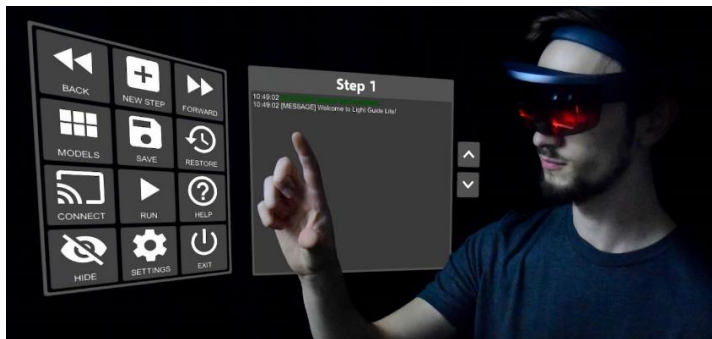

Do not miss your opportunity to see two of the most advanced smart factory solutions available today that incorporate digital work instruction software that connects with production line equipment, such as bar code scanners, torque tools, pick-to-light systems, and smart glasses. We'll demonstrate how digital work instructions can be projected onto work

surfaces and viewed on smart glasses, while also collecting, storing and analyzing historical production data.

About eFlex Systems and Light Guide Systems: The eFlex System and Light Guide are both powerful manufacturing tools when used independently, and even more powerful when combined. The eFlex System is the leading digital transformation platform used to create digital work instructions, connect devices, enforce quality procedures and collect manufacturing data. Light Guide Systems offers the world's most advanced augmented reality projection and wearable manufacturing solutions. Attendees will have the opportunity to participate in a hands-on demonstration of these cutting-edge technologies.

Target Audience: Decision makers who wish to experience the latest technologies around work instructions and hands-free guidance for their operations should attend this event.

Fee: No Cost, but registration is required.

Presenters: **Randy Blaylock**, Vice President, Sales, *eFlex Systems*
Brian Close, Executive Director of Sales, *OPS Solutions, LLC*

Presenter Bios:

Randy Blaylock has 30 years' experience in material logistics, industrial automation, and automation software. Brian Close has 14 years' experience in augmented reality technology and manufacturing process optimization.

To register, please go to: www.mrcpa.org/events